

QUANTUM X5

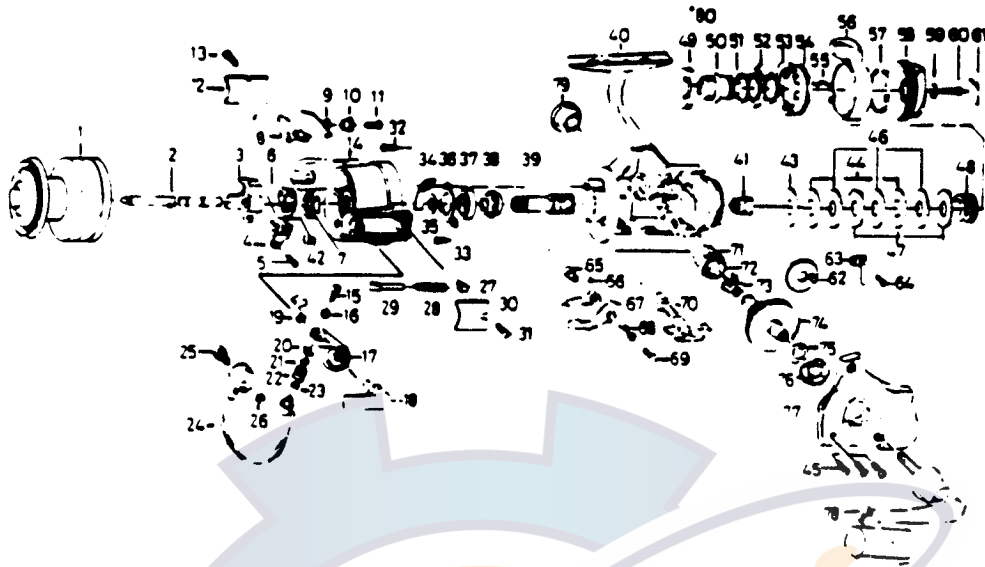

KEY PART NO.	NO.	DESCRIPTION	PRICE	KEY PART NO.	DESCRIPTION	PRICE
	DK321-1	SPOOL ASSY. (EXTRA)	6.88	42	NT058	RTR NUT LOCK SCREW
1	DK321	SPOOL ASSY. (MAIN)	6.88	43	NT039	DRAG WASHER B
2	NT315	MAIN SHAFT	3.73	44	NT041	EARED WASHER
3	NB025	OSCILLATOR SLIDER	1.95	45	NT057	SIDE COVER SCREW
4	NT083	OSC. SLIDER RETAINER	.98	46	NT046	DRAG WASHER C
5	NT161	OSC. SLIDER SCREW	.85	47	NT030	KEY WASHER
6	NT088	ROTOR NUT LOCK WASHER	1.43	48	NT031	DRAG COIL SPRING
7	NT006	ROTOR NUT	1.27	49	NT112	DRAG NUT A
8	PT019	BAIL TRIP LEVER	2.24	50	NT121	DRAG SCREW
9	NT049	BAIL TRIP LEVER SPRING	.85	51	NT106	DRAG SCREW WASHER A
10	NT137	BAIL TRIP LV. BUSHING	1.09	52	NT110	DRAG HOLDER
11	NT037	BAIL TRIP LEVER SCREW	.85	53	NT111	DRAG SCREW WASHER B
12	NT024	BAIL TRIP COVER	1.09	54	NT117	DRAG NUT B
13	NT085	BAIL SPG COVER SCRW	1.09	55	NT118	DRAG SPRING
14	DK009	ROTOR	5.44	56	CK094	POWER LEVER
15	NT108	BAIL SCREW	1.27	57	NT095	POWER LEVER RETAINER
16	NT102	LOCK WASHER	.46	58	NT032	DRAG KNOB
17	NT007	BAIL ARM	1.83	59	NT119	DRAG KNOB WASHER
18	NT115	CAM CAST LEVER	5.68	60	NT079	DRAG KNOB SCREW
19	NT002	CAM CAST LV. RETAINER	.46	61	NT120	DRAG KNOB NAME PLATE
20	NT017	LINE ROLLER COLLAR	.46	62	NT053	OSCILLATING GEAR
21	NT015	LINE ROLLER	.46	63	NT068	CLICK LEAF SPRING
22	NT004	LINE ROLLER	1.72	64	NT067	CLICK LEAF SPRING SCRW
23	NT016	LINE ROLLER BUSHING	.46	65	NT014	ANTI-REV PAWL COLLAR
24	PT347	BAIL	4.02	66	NT063	ANTI-REV. PAWL A
25	NT044	BAIL HOLDER PIN	1.83	67	NT064	ANTI-REV. PAWL B
26	NT003	BAIL TRIP CAM RET.	.85	68	NT061	ANTI-REV PAWL SPG A
27	NT020	BAIL SPG SHAFT HLD	.98	69	NT089	ANTI-REV PAWL SCREW
28	NT022	BAIL SPRING	.46	70	NT059	ANTI-REV. LEVER
29	NT029	BAIL SPRING SHAFT	1.09	71	NT052	BUSHING
30	NT087	BAIL SPRING COVER	.98	72	NT253	OSCILLATING PN GEAR
31	NT085	BAIL SPG COVER SCRW	1.09	73	NT086	ANTI-REV PAWL SPG B
32	NT080	BEARING RET.SCREW A	.98	74	CK012	DRIVE GEAR
33	NT093	BEARING RET.SCREW B	.85	75	NT026	DRIVE GEAR WASHER
34	NT082	BAIL TRIP PLATE	1.43	76	NT157	BALL BEARING
35	NT027	PINION WASHER	.85	77	DK323	SIDE COVER
36	NT040	BEARING RETAINER	1.83	78	DK318	HANDLE ASSY.
37	NT028	BALL BEARING	9.12	79	NT073	HANDLE SCREW CAP
38	NT060	ANTI-REV. RATCHET	3.73	80	NT121	DRAG SCREW
39	NT011	PINION GEAR	6.82			
40	DK301	BODY	9.46			
41	NT066	CLICK GEAR	1.83			

*Not pictured
Located between Keys 48 & 50

Prices subject to change without notice. Prices do not include postage and handling.

PLEASE ORDER BY PART NUMBER

Rev. 11/80

Zebco Division Brunswick Corporation, Box 270, Tulsa, OK 74101 USA 918-686-8881

